

# HSF

NOTES:  
 Current Rating:0.5AMP  
 Contact Resistance:30mΩ max  
 Withstand Voltage:100V AC/DC  
 Insulation Resistance:500MΩ min  
 Operation Temperature:-40℃ to +125℃

Contact Material:Phosphor Bronze  
 Cap Material:SUS,t=0.25mm  
 Housing Material:LCP/PA9T(UL94V-0),Nature  
 Contact plating:Au and Tin over Ni

Flatness: <80Pins The "M" Is 0.12mm MAX  
 ≥80Pins The "M" Is 0.15mm MAX

### Ordering Information

3616-P XXX - XXX XX R XX

No.of Pins    Housing High    Contact Plating    R=Tape&Reel+CAP  
 Male=H1    S1=3u"Gold/Tin    S3=10u"Gold/Tin

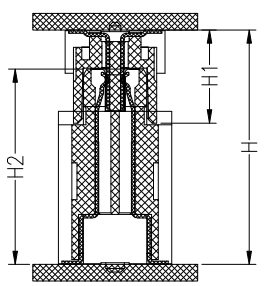

Assembly

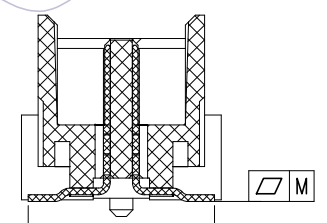
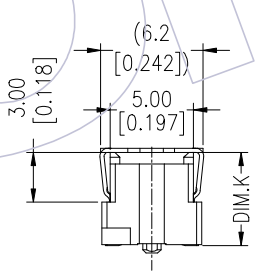
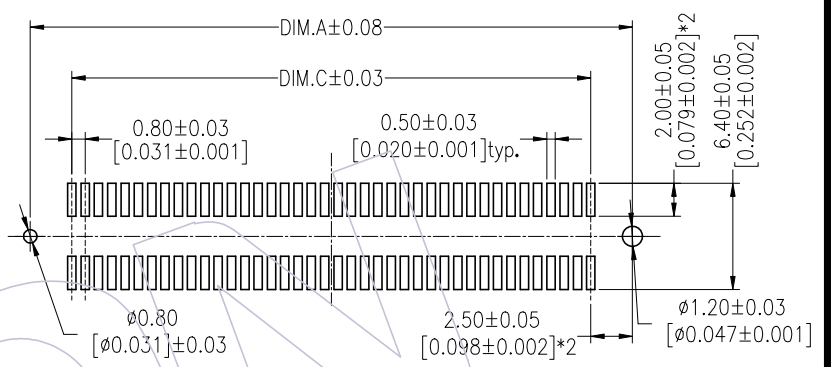
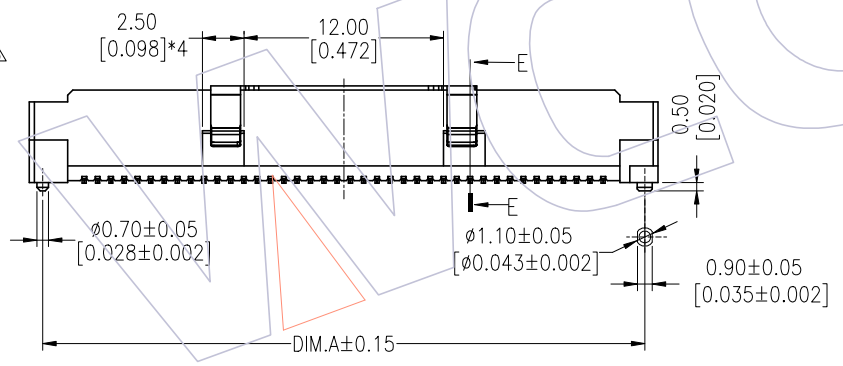
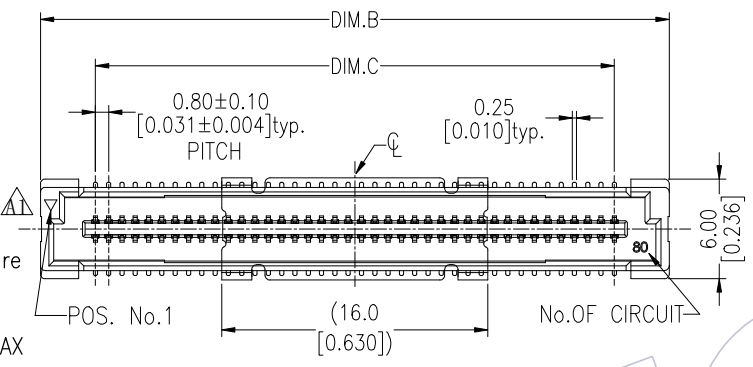

SECTION E-E  
SCALE 2:1

PART NO.	DIM.K (MALE HEIGHT)	ASS'Y HEIGHT (H)	PLUG (H1)	SOCKET (H2)	ASS'Y HEIGHT (H)	PLUG (H1)	SOCKET (H2)	ASS'Y HEIGHT (H)	PLUG (H1)	SOCKET (H2)
3616-PXXX-046XXR01	4.60	5.00	4.60	3.75	9.00	4.60	7.75	13.00	4.60	11.75
3616-PXXX-056XXR01	5.60	6.00	5.60		10.00	5.60		14.00	5.60	
3616-PXXX-066XXR01	6.60	7.00	6.60		11.00	6.60		15.00	6.60	
3616-PXXX-076XXR01	7.60	8.00	7.60		12.00	7.60		16.00	7.60	

79.20	85.80	84.20	200
71.20	77.80	76.20	180
63.20	69.80	68.20	160
55.20	61.80	60.20	140
47.20	53.80	52.20	120
39.20	45.80	44.20	100
31.20	37.80	36.20	80
23.20	29.80	28.20	60
15.20	21.80	20.20	40
DIM.C	DIM.B	DIM.A	PIN NO.

REV	DATE	MODIFICATION DESCRIPTION	CHANGE	OPERATION	DRAW	DATE	SCALE	FIT	PART NO.
A3	2022/02/24	Add Housing Material		OPERATION	DRAW	2022/02/24	SCALE	FIT	3616-PXXX-XXXXRXX
A2	2014/11/07	Modify		x.x ±0.40	GH		UNIT	mm	TITLE: 0.80mm B TO B "T" MALE 180° SMT TYPE
A1	2014/08/21	Modify		x.xx ±0.25	CHECK	DATE	SIZE	A4	
A0	2013/04/22	NEW		x.xxx ±0.15	APPROVE	DATE	SHEET	1/2	
REV	DATE	MODIFICATION DESCRIPTION	CHANGE	Angle ± 3° DIM TOL		DATE	PROJ.		Customer NO.

**WCON**  
 Http: www.wcon.com

WCON-Dongguan    WCON-Kunshan  
 Tel: +86 769 85358920    Tel: +86 512 57468408  
 Fax: +86 769 85358915    Fax: +86 512 57468468  
 E-mail: sales@wcon.com    E-mail: salesks@wcon.com

# HSF

## PLUG

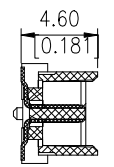

3616-PXXX-046XXR01

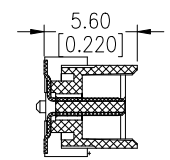

3616-PXXX-056XXR01

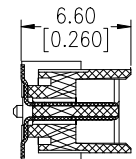

3616-PXXX-066XXR01

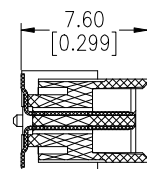

3616-PXXX-076XXR01

## RECEPTACLE

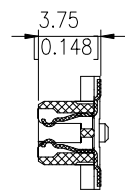

3616-SXXX-037XXR01

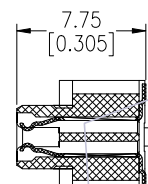

3616-SXXX-077XXR01

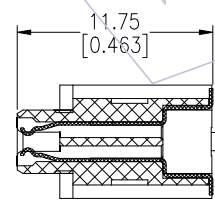

3616-SXXX-117XXR01

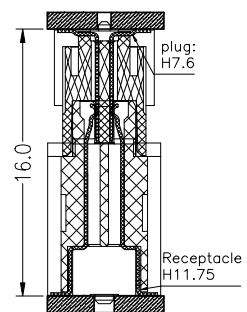
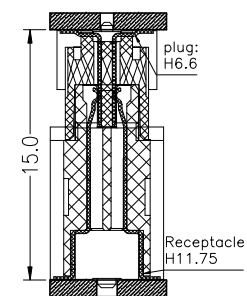
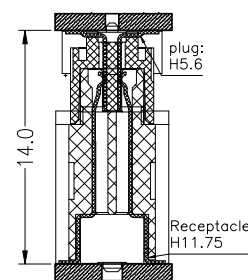
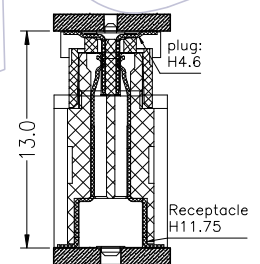
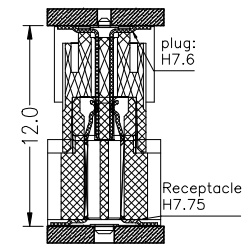
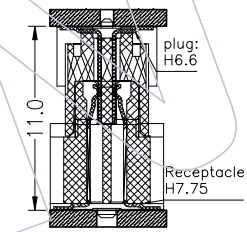
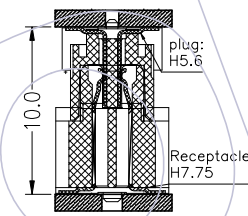
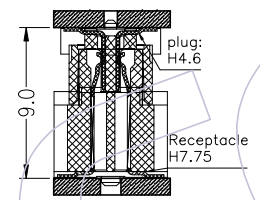
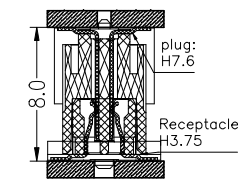
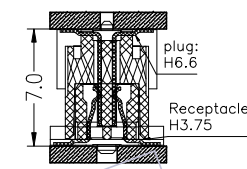
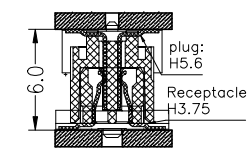
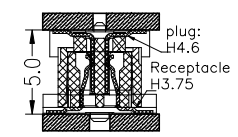

REV	DATE	MODIFICATION DESCRIPTION	CHANGE	OPERATION	DRAW	DATE	SCALE	FIT	PART NO.
A3	2022/02/24	Add Housing Material		OPERATION	GH	2022/02/24	UNIT	mm	3616-PXXX-XXXXRXX
A2	2014/11/07	Modify		x.X ±0.40	CHECK	DATE	inch	SIZE	
A1	2014/08/21	Modify		x.XX ±0.25	APPROVE	DATE	SHEET	2/2	0.80mm B TO B "T" MALE 180° SMT TYPE
A0	2013/04/22	NEW		x.XXX ±0.15			PROJ.		
				Angle ± 3'					Customer NO.
				DIM TOL					

Http: [www.wcon.com](http://www.wcon.com)

WCON-Dongguan Tel: +86 769 85358920 Fax: +86 769 85358915 E-mail: <a href="mailto:sales@wcon.com">sales@wcon.com</a>	WCON-Kunshan Tel: +86 512 57468408 Fax: +86 512 57468468 E-mail: <a href="mailto:salesks@wcon.com">salesks@wcon.com</a>
---	--