

# HSF

Recommended P.C.B Layout (Top Side)  
(PCB BOARD TOLERANCE ±0.05)

NOTES:  
 Rated Current: 2.0AMP.  
 Contact Resistance: 20mΩ Max.  
 Withstand Voltage: 500V AC/DC  
 Insulation Resistance: 1000MΩ Min.  
 Operation Temperature: -40°C to +105°C

Contact Material: Brass  
 Contact Plating: Au or Sn Over Ni  
 Insulator Material: PA9T+33%G.F UL94V-0 BK

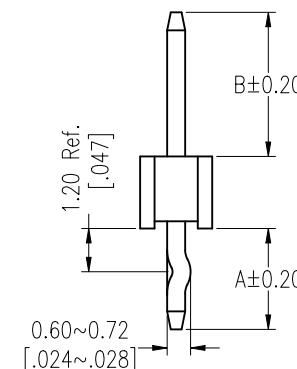
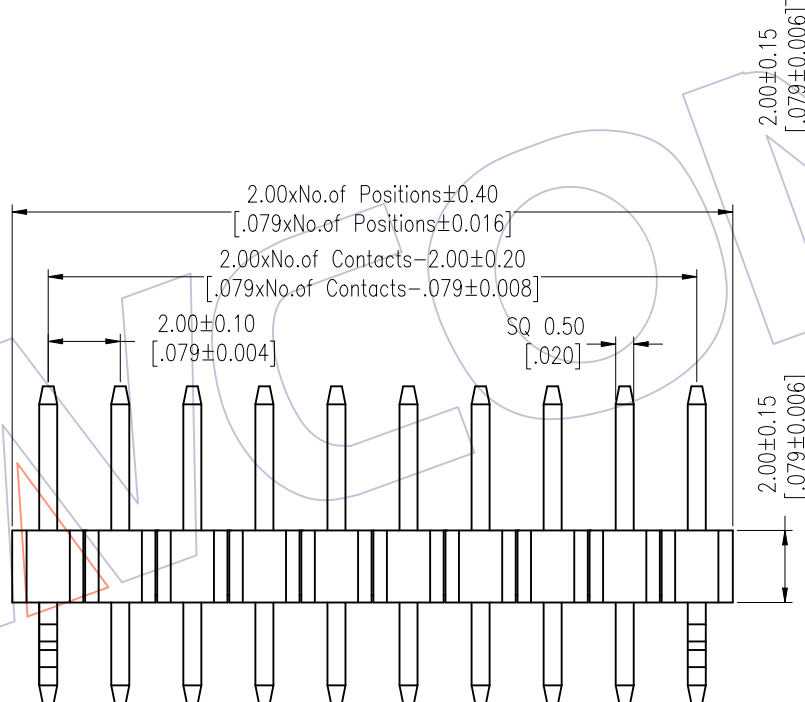
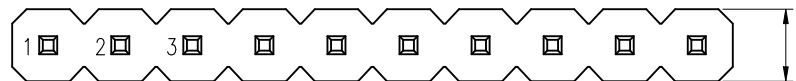
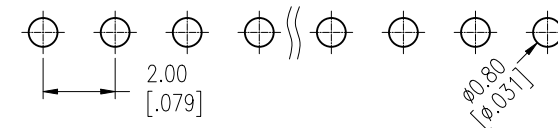

## Ordering Information

1220-11 XX XX K XXX C 0 XX

|             |                   |                  |                    |          |            |
|-------------|-------------------|------------------|--------------------|----------|------------|
| No. of Pins | Contact Plating   | Pin Length       | Insulator Material | Packing  | Series No. |
| 02~40       | G0=Gold Flash     | L=A+B+2.0        | C=PA9T             | 0=PE Bag | 01~99      |
|             | G3=10u"Gold       | Standard:068=6.8 |                    | T=Tube   |            |
|             | G4=15u"Gold       | 078=7.8          |                    |          |            |
|             | G5=30u"Gold       | 088=8.8          |                    |          |            |
|             | S0=Gold Flash/Tin |                  |                    |          |            |
|             | S3=10u"Gold/Tin   |                  |                    |          |            |
|             | S4=15u"Gold/Tin   |                  |                    |          |            |
|             | S5=30u"Gold/Tin   |                  |                    |          |            |
|             | SN=Tin            |                  |                    |          |            |
|             | SM=Matte Tin      |                  |                    |          |            |

| Item      | Pin Length | A    | B    | Mating                |
|-----------|------------|------|------|-----------------------|
| Standard  | 6.80       | 2.80 | 2.00 | 2220T 2221 2227T 2228 |
|           | 7.80       | 2.80 | 3.00 | 2235                  |
|           | 8.80       | 2.80 | 4.00 | 2240 2243 2263 2272   |
| Alternate |            |      |      |                       |

| OPERATION   | DRAW       | DATE       | SCALE | Fit | PART NO.  |
|-------------|------------|------------|-------|-----|---|
| X.X ±0.40   | <i>Liu</i> | 2018.01.18 | UNIT  | mm  | 1220-11XXXXXXC0XX                                   |
| X.XX ±0.25  | CHECK      | DATE       | SIZE  | A4  | TITLE:<br>PH2.0 SINGLE ROW<br>180° H=2.0 KINKED-PIN |
| X.XXX ±0.15 | APPROVE    | DATE       | SHEET | 1/1 | Customer NO.  |
| Angle ± 3'  |            |            | PROJ. |     |   |
| DIM TOL     |            |            |       |     |   |

**WCON**  
 Http: www.wcon.com  
 WCON-Dongguan Tel: +86 769 85358920  
 WCON-Kunshan Tel: +86 512 57468408  
 Fax: +86 769 85358915  
 Fax: +86 512 57468468  
 E-mail: sales@wcon.com  
 E-mail: salesks@wcon.com

| REV | DATE       | MODIFICATION DESCRIPTION | CHANGE |
|-----|------------|--------------------------|--------|
| A1  | 2018/01/18 | Modify P/N               |        |
| A0  | 2012/04/26 | NEW                      | -----  |