

NOTES:
 Rated Current:1.0AMP
 Rated Voltage:50V AC/DC
 Contact Resistance:20mΩ max
 Withstand Voltage:500V AC/Minute
 Insulation Resistance:500MΩ min
 Operation Temperature:-25℃ to +85℃
 Insulator Material:PA6T+30%G.F UL94V-0

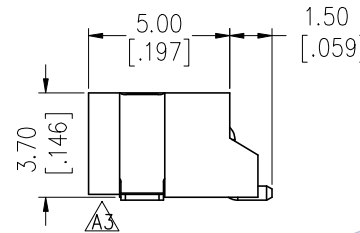

Recommended P.C.B Layout
 (PCB BOARD TOLERANCE±0.05)

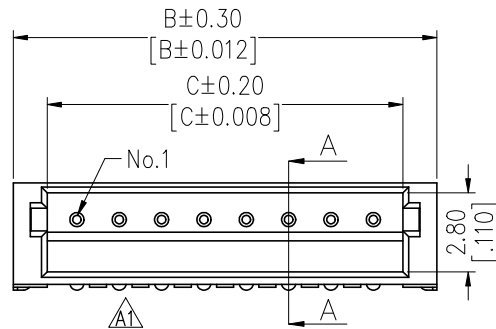
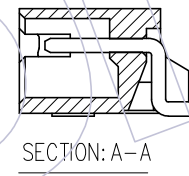
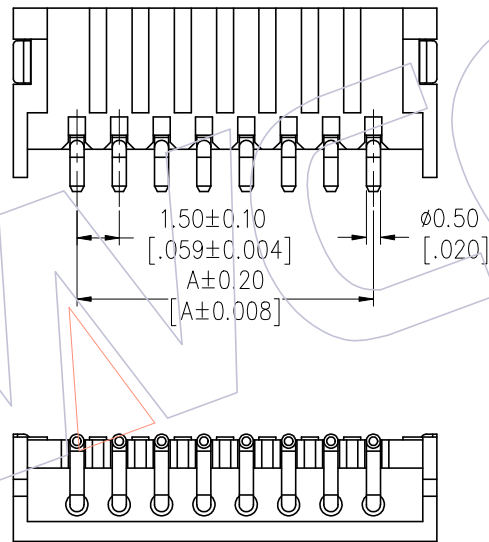
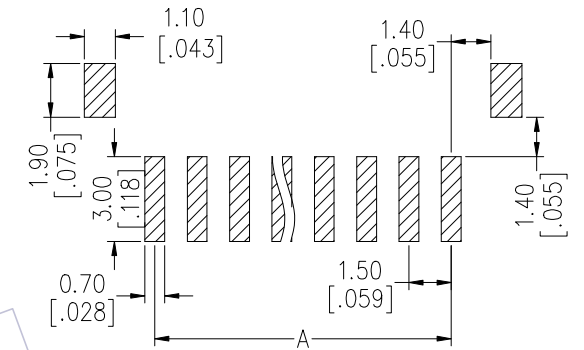

Ordering Information

WF1501 - WZ XX X X 1

No. of pins
02~15P

Contact Plating
S0=Gold Flash/Tin
S3=10u"Gold/Tin
S4=15u"Gold/Tin
S5=30u"Gold/Tin
G0=Gold Flash
G3=10u"Gold
G4=15u"Gold
G5=30u"Gold
Blank=Tin

Color
B=Black
E=Beige
(Natural)

Packing
R=Reel
T=Tube

Specification & Ordering Information:

Circuit	Part No.	Dimension		
		A	B	C
02	WF1501-WZ02XX1	1.50	6.00	3.60
03	WF1501-WZ03XX1	3.00	7.50	5.10
04	WF1501-WZ04XX1	4.50	9.00	6.60
05	WF1501-WZ05XX1	6.00	10.50	8.10
06	WF1501-WZ06XX1	7.50	12.00	9.60
07	WF1501-WZ07XX1	9.00	13.50	11.10
08	WF1501-WZ08XX1	10.50	15.00	12.60
09	WF1501-WZ09XX1	12.00	16.50	14.10
10	WF1501-WZ10XX1	13.50	18.00	15.60
11	WF1501-WZ11XX1	15.00	19.50	17.10
12	WF1501-WZ12XX1	16.50	21.00	18.60
13	WF1501-WZ13XX1	18.00	22.50	20.10

REV	DATE	MODIFICATION DESCRIPTION	CHANGE	OPERATION	DRAW	DATE	SCALE	FIT	PART NO.
A3	2019/04/18	Modify	---	OPERATION	Draw	2019/04/18	UNIT	mm	WF1501-WZXXXX1
A2	2014/11/21	Modify	---	x.X ±0.40	Check	DATE	SIZE	A4	TITLE:
A1	2013/04/26	PA6T+30%G.F--PA9T,MODIFIY THE DRAWING	---	x.XX ±0.25	APPROVE	DATE	SHEET	1/1	ZH 1.50 WAFER 90° SMT
AO	2012/09/03	NEW	---	x.XXX ±0.15	APPROVE	DATE	PROJ.	Customer NO.	
				Angle ± 3°					
				DIM TOL					



WCON-Dongguan
 Tel: +86 769 85358920
 Fax: +86 769 85358915
 E-mail: sales@wcon.com

WCON-Kunshan
 Tel: +86 512 57468408
 Fax: +86 512 57468468
 E-mail: salesks@wcon.com