

HSF

NOTES:

Rated Voltage: 250V.
 Withstand Voltage: 1500V AC
 Insulation Resistance: 1000MΩ Min.
 Operation Temperature: -55℃ to +105℃
 Material: PBT+G.F.UL94V-0, Black
 Mating Terminal: WD3810-3TD3XXXXXX

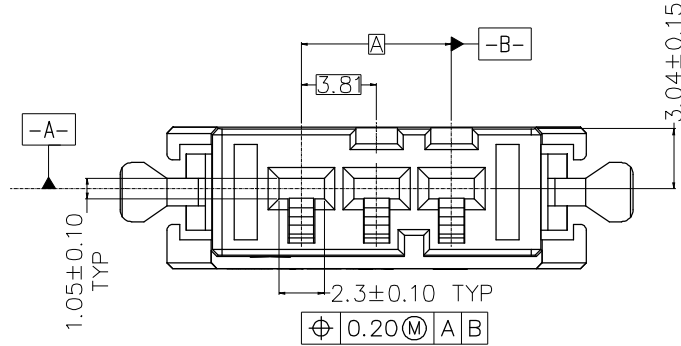

Part NO.	Foolproof code	Pin	A	B	△C	E
WD3810-1H03B001X	X	3	7.62	16.70	21.32	26.07
WD3810-1H03B002X	Y					
WD3810-1H04B001X	X	4	11.43	20.51	25.13	29.88
WD3810-1H04B002X	Y					
WD3810-1H05B001X	X	5	15.24	24.32	28.94	33.69
WD3810-1H06B001X	X					
WD3810-1H06B002X	Y	6	19.05	28.13	32.75	37.50
WD3810-1H08B001X	X					
WD3810-1H10B001X	X	10	34.29	43.37	47.99	52.74
WD3810-1H10B002X	Y					

Ordering Information

WD3810 -1 H XX B O XX X

Row: _____
 1=Single

Receptacle Housing

No of Pins:
 03=3Pin, 04=4Pin,
 05=5Pin, 06=6Pin,
 08=8Pin, 10=10Pin

Housing Color:
 B=Black

Foolproof Type:
 01=X
 02=Y

Packing:
 0=PE Bag

W="Wcon" logo
 M=Customer logo
 Blank=Without logo

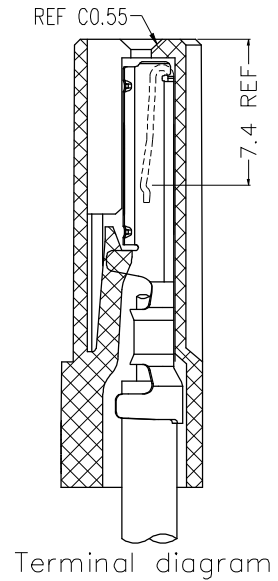
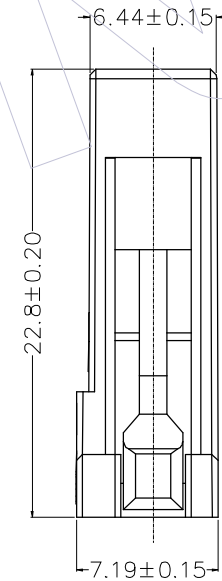
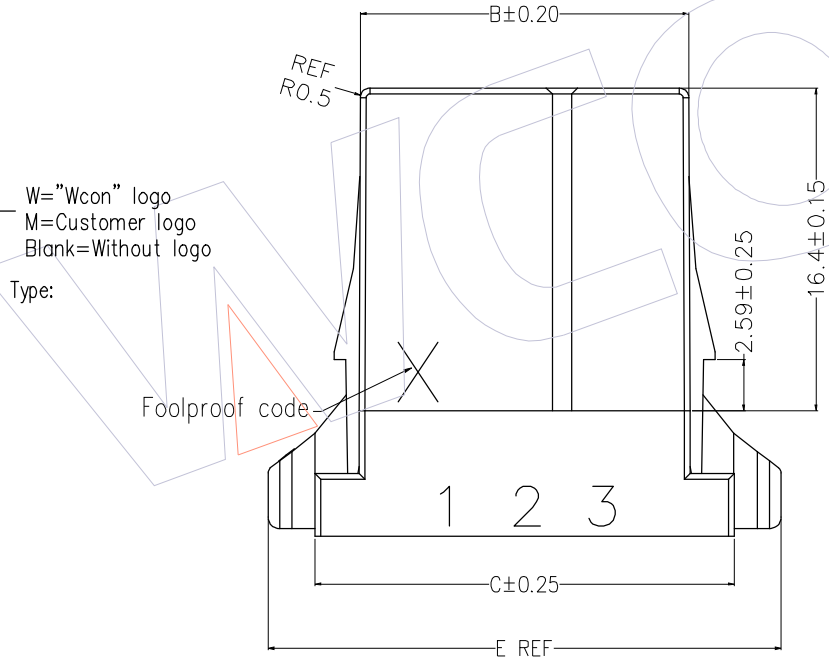

REV	DATE	MODIFICATION DESCRIPTION	CHANGE	OPERATION	DRAW	DATE	SCALE	Fit	PART NO.
A1	2022/06/08	Correct DIM.C	XSR	x.x ±0.40	XSR	2022/06/08	UNIT	mm	WD3810-1HXXB0XXX
AO	2021/06/23	NEW	OHJ	x.xx ±0.25	CHECK	DATE	SIZE	A4	TITLE: 3.81mm Dyn. Housing (T Type) Single Row
				x.xxx ±0.15	APPROVE	DATE	SHEET	1/2	Customer NO.
				Angle ± 3°			PROJ.		
				DIM TOL					

WCON
 Http: www.wcon.com

WCON-Dongguan
 Tel: +86 769 85358920
 Fax: +86 769 85358915
 E-mail: sales@wcon.com

WCON-Kunshan
 Tel: +86 512 57468408
 Fax: +86 512 57468468
 E-mail: salesks@wcon.com

HSF

WD3810-1HXXB001

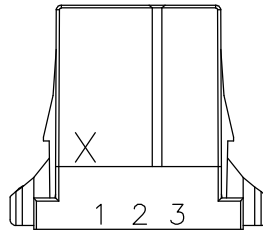

WD3810-1HXXB001W

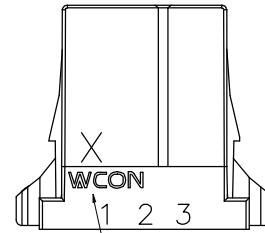

With "wcon" LOGO

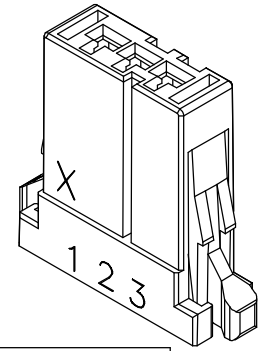

Foolproof diagram

	3P	4P	10P
X	 WD3810-1H03B001X	 WD3810-1H04B001X	 WD3810-1H10B001X
Y	 WD3810-1H03B002X	 WD3810-1H04B002X	 WD3810-1H10B002X
	5P	6P	8P
X	 WD3810-1H05B001X	 WD3810-1H06B001X	 WD3810-1H08B001X
Y		 WD3810-1H06B002X	

				OPERATION	DRAW	DATE	SCALE	Fit	PART NO.
				x.x ±0.40	XSR	2022/06/08	UNIT	mm	WD3810-1HXXB0XXX
A1	2022/06/08	Correct DIM.C	XSR	x.xx ±0.25	CHECK	DATE	SIZE	A4	TITLE:
AO	2021/06/23	NEW		x.xxx ±0.15	APPROVE	DATE	SHEET	2/2	3.81mm Dyn. Housing (T Type)
REV	DATE	MODIFICATION DESCRIPTION	CHANGE	Angle ± 3°			PROJ.		Customer NO.
				DIM TOL					

WCON

Http: www.wcon.com

WCON-Dongguan Tel: +86 769 85358920 Fax: +86 769 85358915 E-mail: sales@wcon.com	WCON-Kunshan Tel: +86 512 57468408 Fax: +86 512 57468468 E-mail: salesks@wcon.com
---	--